

ADAPTOR REDUCING

Brand Name: **elson**

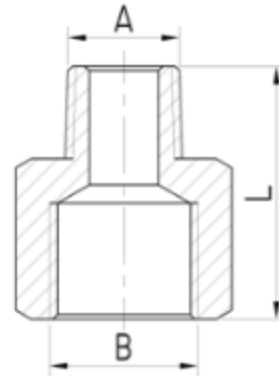

CODE	DESCRIPTION	L(mm)	A	B
80215	ADAPTOR REDUCING 6mmF x 4mmM (1/4" x 1/8") BRS	22	R1/8	G1/4
80220	ADAPTOR REDUCING 10mmF x 6mmM (3/8" x 1/4") BRS	28.4	R1/4	G3/8
80222	ADAPTOR REDUCING 15mmF x 6mmM (1/2" x 1/4") BRS	30.4	R1/4	G1/2
80224	ADAPTOR REDUCING 15mmF x 10mmM BRS	31.8	R3/8	G1/2
80226	ADAPTOR REDUCING 20mmF x 15mmM BRS	30	G1/2B	G3/4
80228	ADAPTOR REDUCING 20mmF x 15mmM CP	30	G1/2B	G3/4
80230	ADAPTOR REDUCING 25mmF x 15mmM BRS	40.1	R1/2	G1
80232	ADAPTOR REDUCING 25mmF x 20mmM BRS	39.4	R3/4	G1
80234	ADAPTOR REDUCING 32mmF x 20mmM BRS	43.4	R3/4	G1 1/4
80236	ADAPTOR REDUCING 32mmF x 25mmM BRS	46	R1	G1 1/4
80238	ADAPTOR REDUCING 40mmF x 25mmM BRS	47	R1	G1 1/2
80240	ADAPTOR REDUCING 40mmF x 32mmM BRS	48.3	R1 1/4	G1 1/2
80244	ADAPTOR REDUCING 50mmF x 40mmM BRS	52.3	R1 1/2	G2

Product Specification & Features

- Maximum Working Temperature: 95°C
- Maximum Working Pressure at 20°C : Water-2000Kpa, Gas-500KPa
- Threads: Complies with AS ISO 7.1, AS ISO 7.2 and AS 1722.2
- Material: DR Brass, Complies with AS 2345
- Suitable for Potable Water – complies with AS/NZS 4020



Elson Australasia Pty Ltd

Tel: 02 9625 7899 Fax: 02 9625 7855

Website: www.elson.net.au E-mail: sales@elson.net.au

Version 1.0
Nov. 2020