

UNION DOUBLE CxC

Brand Name: **elson**

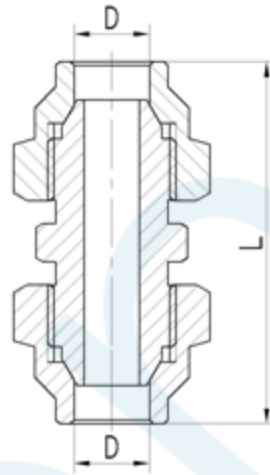

CODE	DESCRIPTION	L(mm)	D
85020	UNION DBL FLRD CxC 10mmFLx10mmFL BR	47	DN10
85022	UNION DBL FLRD CxC 15mmFLx15mmFL BR	52.5	DN25

Product Specification & Features

- Maximum Working Temperature: 95°C
- Maximum Working Pressure at 20°C : 2000Kpa
- Threads: Complies with AS 1722.2
- Material: DR Brass, Complies with AS 2345
- Suitable for Potable Water – complies with AS/NZS 4020

Standards & Approvals



Elson Australasia Pty Ltd

Tel: 02 9625 7899 Fax: 02 9625 7855

Website: www.elson.net.au E-mail: sales@elson.net.au

Version 1.0

Nov. 2020