

UNION C×M COPPER OLIVE

Brand Name: **elson**

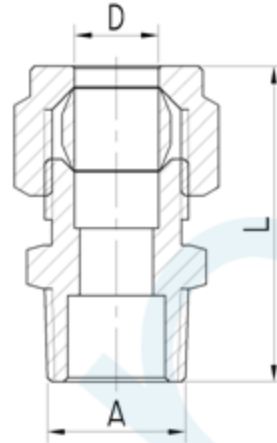

CODE	DESCRIPTION	L(mm)	D	A
87084	UNION CxM 10mm C x 10mm MI BRS C/O	36.5	DN10	R3/8
87086	UNION CxM 15mm C x 10mm MI BRS C/O	37	DN15	R3/8
87088	UNION CxM 10mm C x 15mm MI BRS C/O	40.5	DN10	R1/2
87090	UNION CxM 15mm C x 15mm MI BRS C/O	40.5	DN15	R1/2
87091	UNION CxM 15mm C x 15mm MI CP C/O	40.5	DN15	R1/2
87092	UNION CxM 20mm C x 20mm MI BRS C/O	46	DN20	R3/4
87094	UNION CxM 15mm C x 20mm MI BRS C/O	43.5	DN15	R3/4
87096	UNION CxM 20mm C x 15mm MI BRS C/O	44	DN20	R1/2
87098	UNION CxM 25mm C x 25mm MI BRS C/O	53.5	DN25	R1

Product Specification & Features

- Maximum Working Temperature: 95°C
- Maximum Working Pressure at 20°C : 2000Kpa
- Threads: Complies with AS 1722.2, AS ISO 7.1, AS ISO 7.2
- Material: DR Brass, Complies with AS 2345
- Suitable for Potable Water – complies with AS/NZS 4020



Elson Australasia Pty Ltd

Tel: 02 9625 7899 Fax: 02 9625 7855

Website: www.elson.net.au E-mail: sales@elson.net.au

Version 1.0

Nov. 2020